



PICKUP PORTS

Outside Air (Horizontal & Vertical)



The ACI Outdoor Pickup Ports are designed to be used in conjunction with any low differential pressure transmitter (see ACI DLP or MLP Series) to provide a weatherproof outdoor reference point for monitoring building static pressure. The A/O-PUP-H is designed to be horizontally mounted with the tube in parallel with the ground or roof. The A/O-PUP-V is designed to be vertically mounted with the tube pointed downwards towards the ground or roof. When used in conjunction with a low differential pressure transmitter the pickup ports provide excellent accuracy and reliability. ACI also offers 10', 20' and 100' Medical tubing kits made of an FDA approved Food/Medical Grade PVC tubing kit. For best results, make sure that the tubing is free of dirt, dust and condensation and that you keep the tubing run as short as possible to provide

best response time. For more information regarding the Medical Grade Tubing kit, please see the specific data sheet for the Medical Grade tubing kit.

Applications: Indoor/Outdoor Weatherproof Pickup Port for Building Static Pressure

The Pick Up Port Series is covered by ACI's Five (5) Year Limited Warranty. The warranty can be found in the front of ACI's Sensors & Transmitters catalog, as well as on ACI's website, www.workaci.com.

PRODUCT SPECIFICATIONS

Tubing Connections:	Barbed fitting accepts 3/16" ID flexible Poly tubing
Maximum Operating Pressure:	Filter: 150 psi (10.3 bar) Medical Tubing (A/10' Tube, A/20' Tube, A/100' Tube): 65 psi maximum at 73°F (23°C)
Operating Temperature Range:	-22° to 185°F (-30° to 85°C)
Storage Temperature Range:	-40° to 185°F (-40° to 85°C)
Enclosure Material Flammability Rating:	ASA/PC with UV Protectant UL 94-V0
Enclosure Color:	Light Gray
Filter Material:	Nickel Plated Brass
Product Dimensions (L x OD x H) Weight:	9.03" (11.4 cm) x 4.30" (6.99 cm) x 2.29" (5.82 cm) 0.60 lbs (0.272 kg)
Agency Approvals:	RoHS2, WEEE, Reach





DIMENSIONAL DRAWING

Pickup Port [Horizontal]

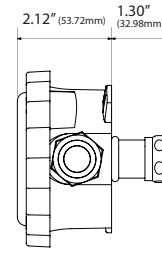
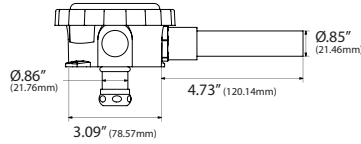
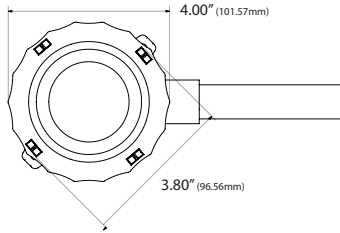

Pickup Port [Vertical]

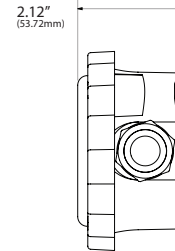
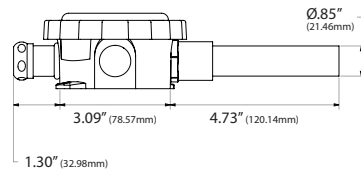
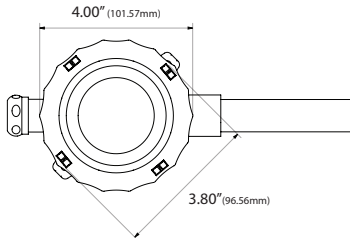

Front View

Right View

Top View

STANDARD ORDERING

Model # Example: **A/O-PUP-H -OR- 132892**

Model #	Item #	Description	Color
A/O-PUP-H	132892	Pickup Port, Horizontal Mount, Outdoor	Light Gray
A/O-PUP-V	132891	Pickup Port, Vertical Mount, Outdoor	Light Gray

ACCESSORIES ORDERING

Model # Example: **A/100'TUBE -OR- 136018**

Model #	Item #	Description	Color
A/10' TUBE	126606	10' Medical Tubing Kit, 1/8" ID x 1/4" OD	Clear
A/20' TUBE	132226	20' Medical Tubing Kit, 1/8" ID x 1/4" OD	Clear
A/100' TUBE	136018	100' Medical Tubing Kit, 1/8" ID x 1/4" OD	Clear

