

1 Description

Aube's TH114 non-programmable thermostat can be used to control the ambient air temperature or floor temperature. You can select among the following temperature control modes:

- A mode:** ▶ controls and displays the ambient air temperature

- F mode:** ▶ controls and displays the floor temperature using an external temperature sensor

- AF mode:**
 - ▶ controls and displays the ambient air temperature
 - ▶ maintains the floor temperature within desired limits using an external temperature sensor

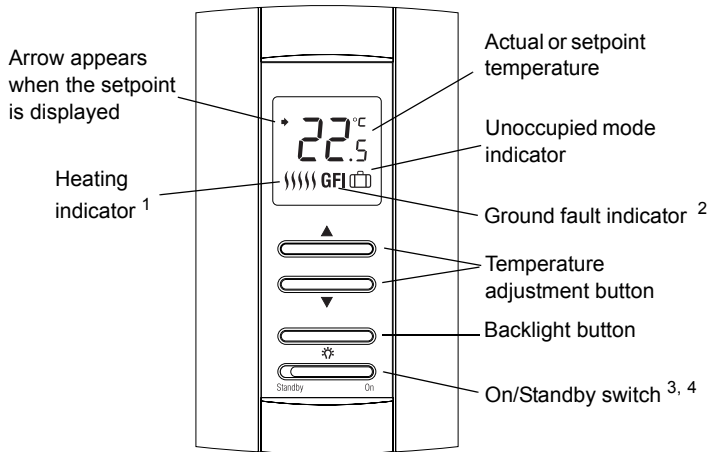

¹ The thermostat displays the percentage use of heating required to maintain the desired temperature. For example, is displayed when heating is at 40 percent.

Display					
% use of heating	1 to 24%	25 to 49%	50 to 74%	75 to 99%	100%

- ² **GFI** appears when the ground fault protection has triggered.
- ³ Place the thermostat in Standby to cut power to the heater when it is not in use (e.g. in summer).
- ⁴ To reset the ground fault protection, switch the thermostat to Standby and back to On.

2 Configuration

The configuration switches are located at the back of the control module (faceplate).

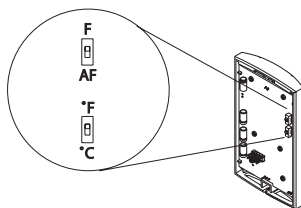

2.1 Temperature Display (S1)

The S1 switch is used to select between °C (default) and °F.

2.2 Temperature Control Mode (S2)

This switch is used to select the temperature control mode.

- F:** To select the F mode
- AF:** To select the A or AF mode (default)

3 Installation

- 1 Refer to the installation instructions of the power base.
- 2 Insert the tabs at the top of the control module in the slots at the top of the power base.
- 3 Secure the control module using the captive screw underneath the base.

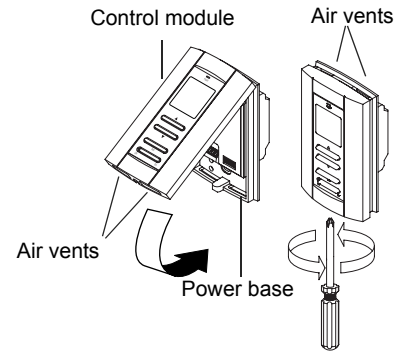

NOTE: Keep the thermostat's air vents clean and unobstructed at all times.

4 Power-up

Upon power-up, the thermostat undergoes a series of tests before displaying the actual (measured) temperature.



5 Error Messages



The measured temperature is below the thermostat's display range. Heating is activated.



The measured temperature is above the thermostat's display range. Heating is deactivated.



Verify the thermostat and sensor connections.

6 Backlight

The display illuminates for 5 seconds when the backlight button is pressed.

When either of the ▲▼ buttons is pressed, the display illuminates for 10 seconds. The setpoint temperature appears for 5 seconds, then the actual (measured) temperature is displayed.

7 Temperature Display and Setting

7.1 Setpoint Temperature

The thermostat normally displays the actual (measured) temperature. To view the setpoint, press once on one of the ▲▼ buttons. The setpoint is displayed for 5 seconds.

To change the setpoint, press one of the ▲▼ buttons until the desired temperature is displayed. To scroll faster, press and hold the button.

7.2 Floor Temperature Limits (AF mode only)

The thermostat generally turns heating On or Off to control the ambient temperature. However, if the floor temperature drops below the set minimum floor temperature limit or rises above the maximum limit, the thermostat will turn heating On or Off respectively, regardless of the ambient temperature, to maintain the floor temperature within the desired limits.

The minimum and maximum floor temperature limits are factory-set at 10 °C (50 °F) and 28 °C (82 °F) respectively. To modify the limits, proceed as follows:



- 1 Switch the thermostat to Standby.
- 2 While pressing any button, switch the thermostat back to On to access the floor temperature limit settings.
- 3 Press the Backlight button briefly to switch between minimum and maximum floor temperature settings.
- 4 Press the ▲▼ buttons to set the desired limit.
- 5 Press the Backlight button for 3 seconds to save your modifications. After the data are saved, the thermostat displays the actual ambient temperature or “—”.

Note: Your modifications are also saved if no button is pressed for 60 seconds.

7.3 Unoccupied Mode

Note: This feature is available only if the thermostat is mounted on a power base that has the unoccupied mode input (ECONO).

The thermostat can be connected to any other remote control device equipped with a dry contact. When the contact closes, the Unoccupied mode is activated and the Unoccupied mode icon is displayed. In this mode, the thermostat lowers its setpoint by 3.5°C (7°F) and all temperature adjustments are blocked except for temporary bypass.

Temporary Bypass

To temporarily bypass the Unoccupied mode, press the backlight button. During the bypass, the Unoccupied mode icon flashes. The bypass is automatically cancelled after 2 hours or if the backlight button is pressed again.

8 Technical Specifications

Power supply: Refer to the power base installation instructions.

Setpoint range - F mode: 5 °C to 40 °C (40 °F to 104 °F)
- A/AF mode: 5 °C to 30 °C (40 °F to 86 °F)

Floor limit range (AF mode): 5 °C to 40 °C (40 °F - 104 °F)

Display range - F mode: 0 °C to 60 °C (32 °F to 140 °F)
- AF mode: 0 °C to 50 °C (32 °F to 122 °F)

Resolution: ± 0.5 °C (1.0 °F)

Duty cycle: Refer to the power base installation instructions.

Storage: -20 °C to 50 °C (-4 °F - 120 °F)

✓ Warranty

Resideo warrants this product, excluding battery, to be free from defects in workmanship or materials, under normal use and service, for a period of three (3) years from the date of first purchase by the original purchaser. If at any time during the warranty period the product is determined to be defective due to workmanship or materials, Resideo shall repair or replace it (at Resideo's option).

If the product is defective,

- (i) return it, with a bill of sale or other dated proof of purchase, to the place from which you purchased it; or
- (ii) call Resideo Customer Care at 1-800-468-1502. Customer Care will make the determination whether the product should be returned to the following address: Resideo Return Goods, 1985 Douglas Dr. N., Golden Valley, MN 55422, or whether a replacement product can be sent to you.

This warranty does not cover removal or reinstallation costs. This warranty shall not apply if it is shown by Resideo that the defect was caused by damage which occurred while the product was in the possession of a consumer.

Resideo's sole responsibility shall be to repair or replace the product within the terms stated above. RESIDEO SHALL NOT BE LIABLE FOR ANY LOSS OR DAMAGE OF ANY KIND, INCLUDING ANY INCIDENTAL OR CONSEQUENTIAL DAMAGES RESULTING, DIRECTLY OR INDIRECTLY, FROM ANY BREACH OF ANY WARRANTY, EXPRESS OR IMPLIED, OR ANY OTHER FAILURE OF THIS PRODUCT.

Some states do not allow the exclusion or limitation of incidental or consequential damages, so this limitation may not apply to you.

THIS WARRANTY IS THE ONLY EXPRESS WARRANTY RESIDEO MAKES ON THIS PRODUCT. THE DURATION OF ANY IMPLIED WARRANTIES, INCLUDING THE WARRANTIES OF MERCHANTABILITY AND FITNESS FOR A PARTICULAR PURPOSE, IS HEREBY LIMITED TO THE THREE YEAR DURATION OF THIS WARRANTY. Some states do not allow limitations on how long an implied warranty lasts, so the above limitation may not apply to you.

This warranty gives you specific legal rights, and you may have other rights which vary from state to state. If you have any questions concerning this warranty, please write Resideo Customer Care, 1985 Douglas Dr. Golden Valley, MN 55422 or call 1-800-468-1502.



Resideo Technologies, Inc.
1985 Douglas Drive North, Golden Valley, MN 55422
1-800-468-1502
www.resideo.com 400-114-000-D M.S. Rev. 04-20

© 2020 Resideo Technologies, Inc. All rights reserved.
This product is manufactured by Resideo Technologies, Inc. and its affiliates.