

## Pneumatic High and Low Temperature Detection Thermostats



134 Pneumatic Low Temperature Detection Thermostat.

### Description

The 134 High and Low Temperature Detection Pneumatic Thermostats automatically “lockout” at setpoint and require manual reset.

### Features

- Snap-acting pneumatic switch
- Sight-set calibrated setpoint scale
- No leakage of air prior to reset of switch
- Easily adjustable settings
- Normally closed air valve; bleeds to less than 2 psi (14 kPa) when supplied through a restrictor
- Barb fitting for push-on connection of 1/4" (6 mm) OD polyethylene tubing
- Holds dead-ended line to approximately 22 psi (152 kPa) air pressure

### Applications

The 134 Pneumatic High and Low Temperature Detection Thermostats are used on pneumatic heating and cooling systems in areas protected from the weather.

On a typical high limit application, the thermostat shuts down air conditioning or ventilating fans when the duct temperature becomes excessively high. A normally closed switch opens at setpoint.

On a typical low temperature application, the thermostat stops the fan or closes a damper when the temperature drops to the setpoint at any one foot (30.5 cm) or more of the sensing element.

F-27

Pneumatics

### Application Drawings

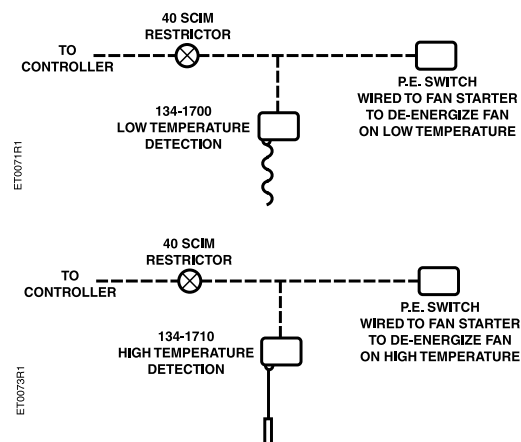
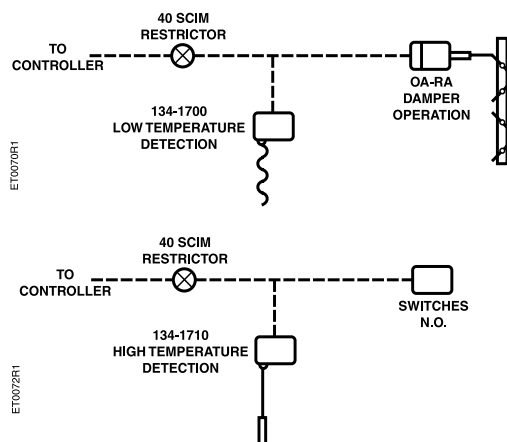

### 134 Pneumatic Thermostat Specifications

**Part No. 134-1700**

Ambient Temperature Range .....Greater than setpoint to 140°F (60°C)  
Pneumatic Switch .....NC, 0.020" (0.6 mm) diameter bleed  
Control Point Low  
Temperature Thermostat .....Lowest temperature at any one foot section of the sensing bulb  
Case Finish .....Gray Baked Enamel  
Shipping Weight .....2.45 lb. (1.11 kg)

**Part No. 134-1710**

Ambient Temperature Range .....-40 to +140°F (-40 to +60°C)  
Pneumatic Switch .....NC, 0.02" (0.6 mm) diameter bleed  
Control Point Low  
Temperature Thermostat .....Lowest temperature at any one foot section of the sensing bulb  
Case Finish .....Gray Baked Enamel  
Shipping Weight .....2.38 lb. (1.08 kg)

### 134 Pneumatic Thermostat Product Ordering

Temp.	Temperature Range	Differential	Max. Bulb Temp.	Bulb & Capillary Length	Switch Reclose	Part No.
Low	15 to 55°F (-9 to +12.8°C) with stop at 35°F (1.67°C)	5°F (2.8°C) Non-Adjustable	400°F (204°C)	20' (6 m)	Temperature must increase by 5°F (2.8°C) before pneumatic switch can be reclosed.	134-1700
High	100 to 170°F (38 to 77°C)	10°F (5.6°C) Non-Adjustable	250°F (121°C)	2.7" (69 mm) Dia. x 10" (25.4 cm) L bulb with 6' (183 mm) capillary	Temperature must drop 10°F (5.6°C) before pneumatic switch can be reclosed.	134-1710

Accessories & Service Kits

F-87

### Dimensions

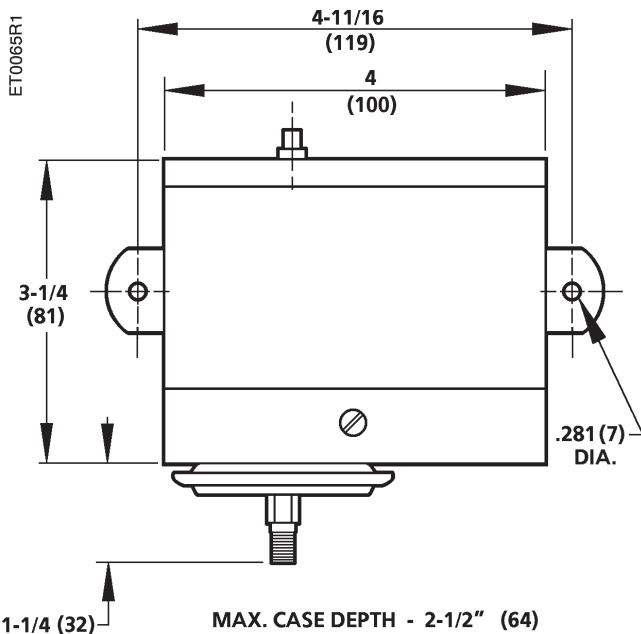

Dimensions shown in inches (mm).