

Multi-purpose Relay



243-0009
Multi-purpose Relay.

Description

The 243 Multi-purpose Relay is pneumatic auxiliary devices designed to provide a variety of pneumatic control functions for the typical control system.

Features

- Use for your most common applications
- High accuracy/repeatability
- Two-valve design prevents constant air loss
- Internal relief mechanism for fail safe operation

Applications

The 243 Multi-purpose Relay is used as direct and reverse acting, amplifying, signal advancing, minimum pressure relay, and lower pressure transfer.

Typical Connections

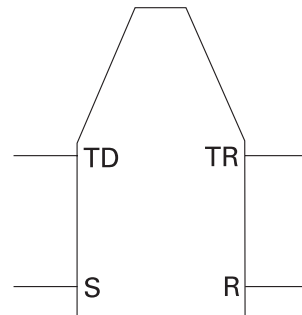

- R** = output
TD = direct acting input
TR = reverse acting input
S = air supply

For more detailed information on applications, refer to page G-27 in the Engineering section.



F-67

Pneumatics

243 Relay Specifications

Ambient Temperature Range		Spring Range	0 to 25 psi (0 to 172 kPa)
Operational.....	40 to 120°F (4 to 49°C)	Air Connections	1/8" NPT
Storage.....	-20 to +120°F (-29 to +49°C)	Spring Adjustment Range	25 psi (0 to 172 kPa)
Hysteresis	0.25 psi (1.7 kPa)	Supply Air	
Relief Valve Differential	1.0 psi (6.9 kPa)	Normal.....	25 psi (172 kPa)
Air Capacity	400 scim (109 ml/s)	Maximum.....	30 psi (207 kPa)
Air Consumption (max.)	7 scim (2 ml/s)	Shipping Weight	1.5 lb. (1.35 kg)

243 Relay Product Ordering

Description	Part No.
Multipurpose Relay	243-0009

Dimensions

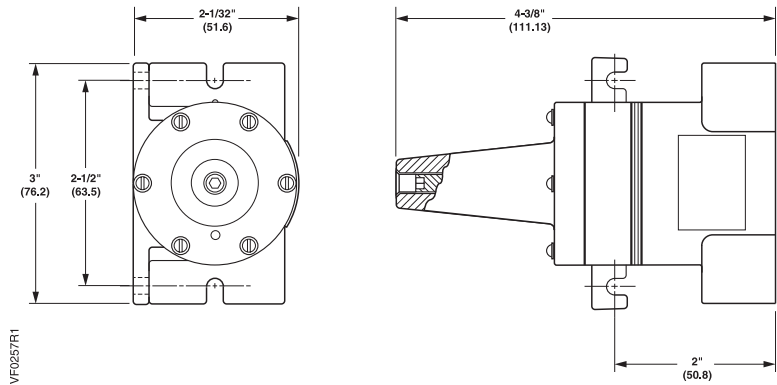

Dimensions shown in inches (mm).